

Output shaft detail  
 Scale 1:5

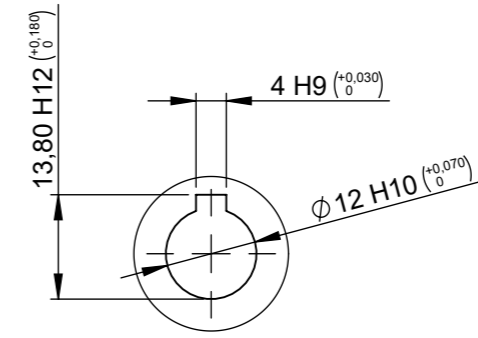

Input shaft detail  
 Scale 1:1

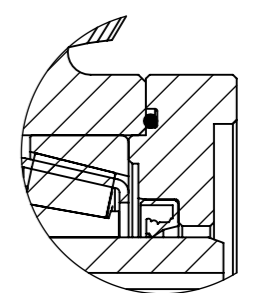

O-ring and Lip seal detail  
 Scale 1:1

SHAFT:  $\phi 12\text{MM}$  KEYED SHAFT

MAIN PERFORMANCE PARAMETERS

GEAR RATIO	62:1	HOLDING TORQUE	950NM
EFFICIENCY	30%	TILTING MOMENT	1,6kNM
SELF-LOCKING GEAR	YES	RADIAL STATIC LOAD	15kN
BACKLASH CLEARANCE	<0,34°	AXIAL STATIC LOAD	27kN
MAXIMUM TORQUE	800NM	RADIAL DINAMIC LOAD	7,6kN
NOMINAL TORQUE	400NM	AXIAL DINAMIC LOAD	8,7kN

NOTES: ALL SLEW DRIVE ARE PRE-LUBRICATED. MAXIMUM OUTPUT SPEED 1RPM.  
 STANDARD PAINT: FOR CORROSION CATEGORY C3-M - BLACK RAL 9005

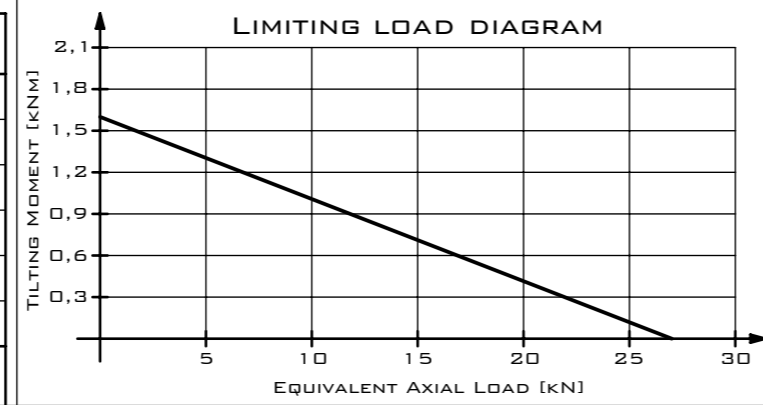

REV.	DESCRIPTION	DATE	NAME	CHECK
D	Fasteners	28/03/22	F.C	T.D
C	Motor & Encoder Cap Modification	29/09/20	D.M.	T.D
B	BOM update	10/07/15	A.C	T.D
A	First Design	13/05/14	G.S	T.D

The information contained in this document is property of TGBgroup. It is not allowable any copy or reproduction of this certificated copy with the original not under control. TGBgroup reserve changes of manufacture without previous advice and duty of communication.

Units: mm

>1200	$\pm 1,2$
>400.0 ~ 1200	$\pm 0,8$
>120.0 ~ 400.0	$\pm 0,5$
>30.0 ~ 120.0	$\pm 0,3$
>6.0 ~ 30.0	$\pm 0,2$
>3.0 ~ 6.0	$\pm 0,1$
>0.3 ~ 3.0	$\pm 0,1$
Range of sizes	Unstated tolerance

**TGBGROUP**

INFO@TGBGROUP.ES  
WWW.TGBGROUP.ES

Reference		<b>BE130-Z1-RM</b>		Rev
Denomination		Sales Drawing		
MATERIAL:	WEIGHT [kg]:	10.27	NUM. PIECES:	1
SCALE:	1:2	SIZE:	A3	SHEET: 1 of 1